

DIMENSIONAL LUMBER

THERMALLY MODIFIED LUMBER for exterior applications



IMPROVED DURABILITY

Expected lifespan of 20-25+ years



BETTER STABILITY

Less susceptible to expansion and contraction

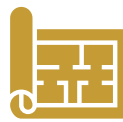

EASY TO WORK WITH

Lighter than traditional building materials



READY TO DELIVER

Most of our inventory can be to your project site within 2 weeks



CUTEK® PREFINISHING SERVICES

All product is available for CUTEK® oil prefinishing





DIMENSIONAL LUMBER



DIMENSIONAL/TRIM OPTIONS

Lumber | Trim | Fascia Board | Screening | Railing, etc

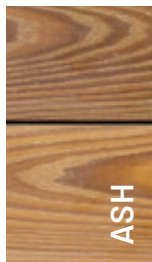

ASH DIMENSIONAL LUMBER - 1x AND 2x

size options

1x ASH	1x2	1x4	1x6	1x8	—	—
2x ASH	2x2	2x4	2x6	2x8	2x10	2x12

actual dimension

.75" thickness, RL 6' - 12'
1.5" thickness, RL 6' - 12'



SY-PINE DIMENSIONAL LUMBER - 1x, 2x AND 4x

size options

1x SY-PINE	1x2	1x4	1x6	1x8	1x10	—
2x SY-PINE	2x2	2x4	2x6	2x8	2x10	2x12
4x SY-PINE	—	4x4	—	—	—	—

(post material)

actual dimension

.75" thickness, RL 8' - 16'
1.5" thickness, RL 8' - 16'
3.5"x3.5", RL 8' - 16'

All dimensional lumber comes in 1' increments

216.771.4080 • SALES@NOLTCO.COM

NORTHERN OHIO offers CUTEK®
prefinishing services: two coats
on all sides of all thermally
modified dimensional lumber

FOUNDED IN 1864,

NORTHERN OHIO is the oldest lumber company and sawmill in Ohio.

Experience and depth of knowledge make us an industry leader and a trusted resource for the professional builder community, architects, designers, and consumers.

NORTHERN OHIO COMPRISES THREE DIVISIONS:



Construction lumber, timber, building materials, and industrial hardwoods



Solid wood high-character lumber, wall siding/cladding, interior and exterior



Fabricated fixtures for hospitality, civic and residential indoor/outdoor